

Worksheet 4-090: Cable tray composite exercise

NB: Students must not attempt this exercise before the correct use of all tools and materials has been demonstrated.

Technical data

- You are to make sure that your work area is clear and safe for work to proceed.
- You are to make sure that all your work conforms to the requirements of the Health and Safety at Work Act.
- All tray joints must be both mechanically and electrically sound.
- When being assessed, the following points will be considered:
 1. positioning
 2. continuity of cpc
 3. standard of assembly
 4. appearance
 5. safety.
- The work area must be restored to a satisfactory condition on completion.

Note: You are required to work on this exercise jointly with the other trainee in the same cubicle. This requires you, first of all, to jointly assess the exercise requirements and to jointly carry them out to the best of your combined capabilities.

Material required

- Previous tasks, as detailed on drawing
- 4-way 60 amp metal clad consumer unit.
- Tray fixing pins/nuts, masonry fixings, etc. Sizes and quantities to be determined from previous knowledge and exercise information.

Procedure

1. Enter the start time on the assessment sheet.
2. Prepare the material requisition (remember to specify actual quantities required for all items and you will also need fixings for the tray and accessories).
3. **Have the requisition checked before proceeding.**
4. Obtain the material from the stores.
5. Fix the tray to the surfaces, as specified in the diagram. Remember that your tray must join up with your partner's tray in two places, ie along the back wall adjacent to the consumer unit and also along the ceiling.
6. **Have your work checked and assessed before proceeding.**
7. Enter the finish time on the assessment sheet.
8. Proceed to the next Worksheet (4-100).

This exercise MUST be bonded to earth

Note: Not To Scale

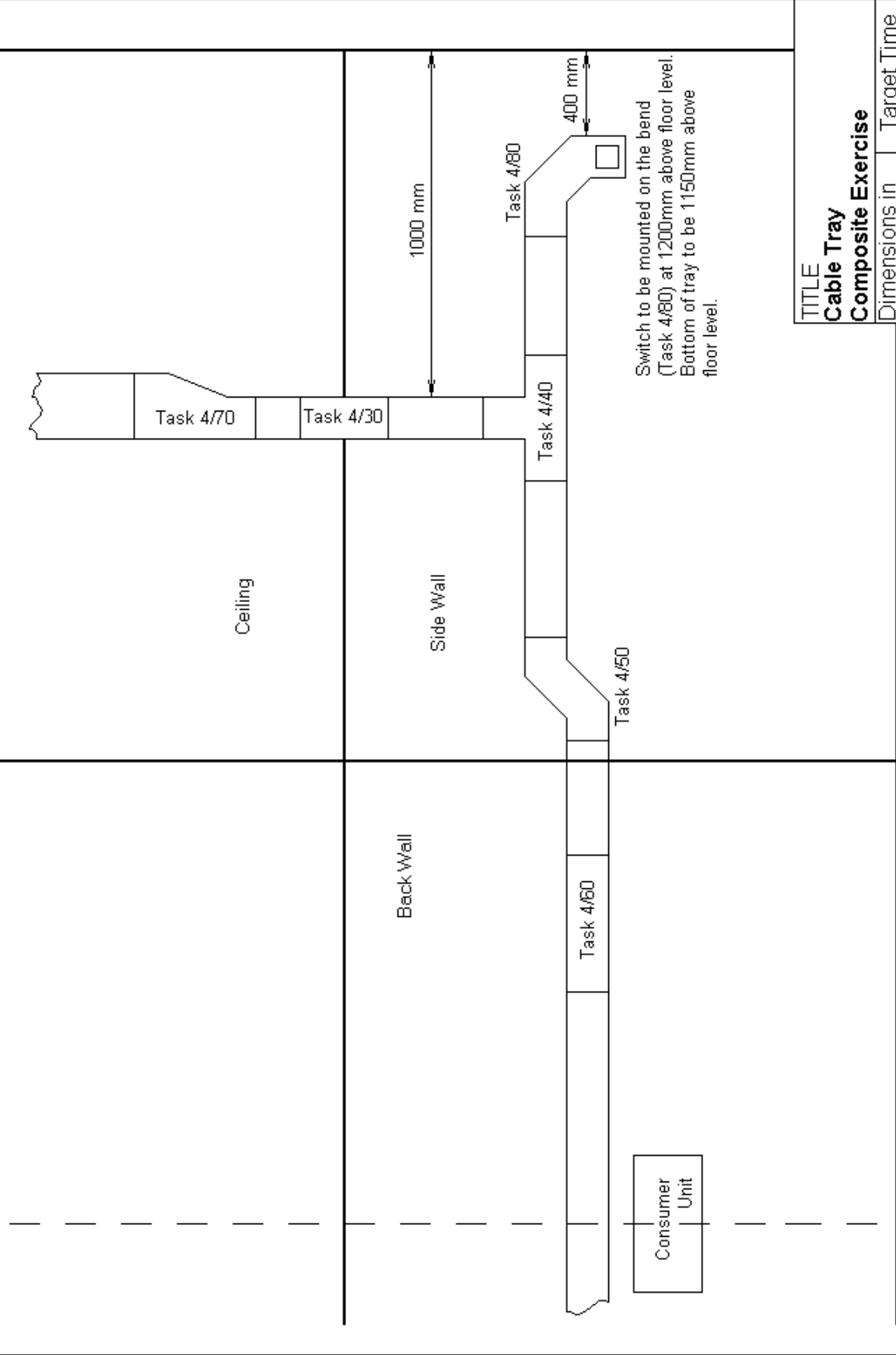

TITLE

**Cable Tray
Composite Exercise**

Dimensions in Millimeters	Target Time 6 hrs.
Scale N.T.S.	Task 4/090

Note: Not To Scale

This exercise **MUST** be bonded to earth

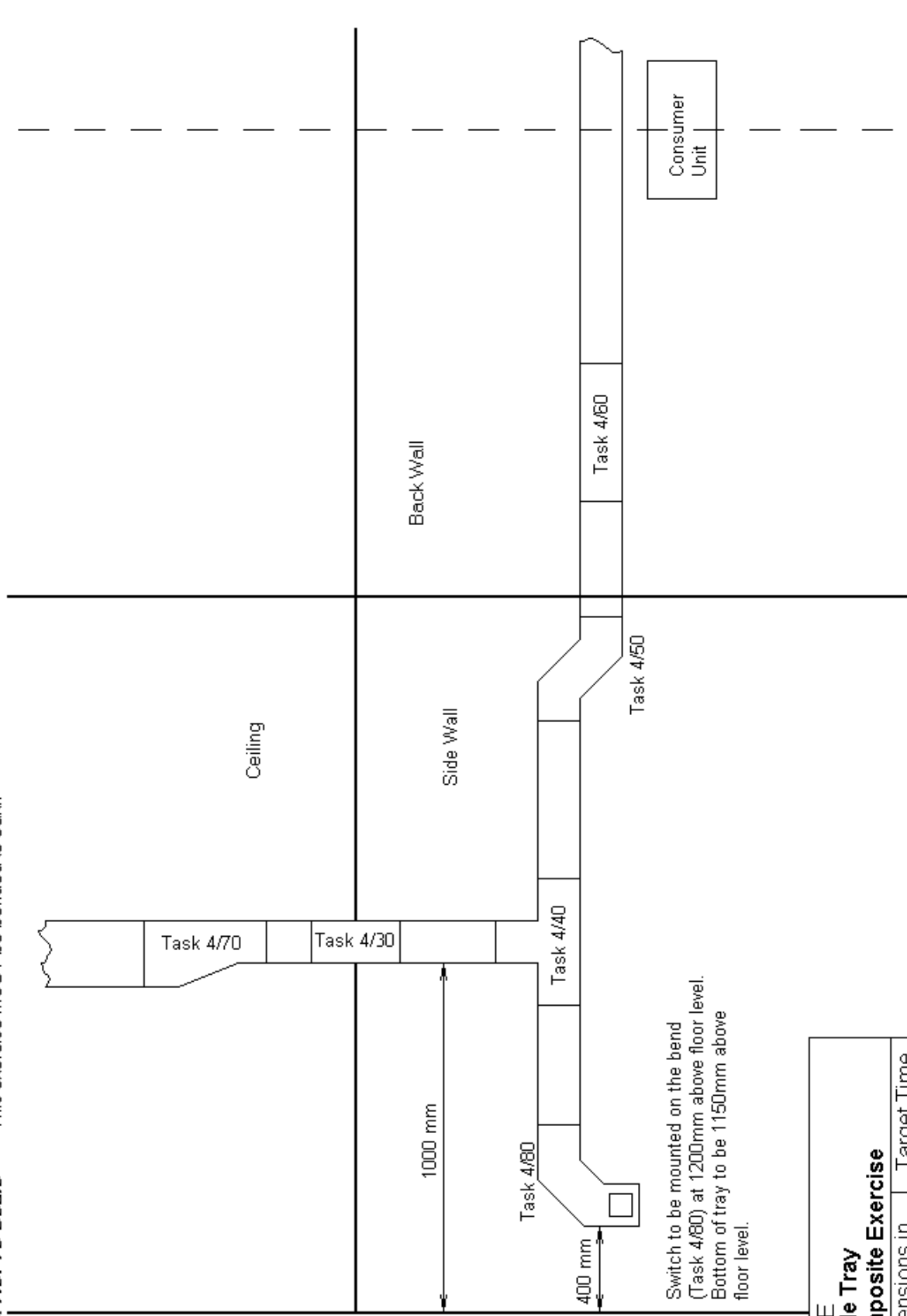

TITLE

**Cable Tray
Composite Exercise**

Dimensions in Millimeters	Target Time 6 hrs.
Scale N.T.S.	Task 4/090

Assessments are based on **observed** safety procedures, and the **quality** and **accuracy** of the completed exercise.

		YES	NO
1.	Material requisition correct first time	<input type="checkbox"/>	<input type="checkbox"/>
2.	Method statement completed	<input type="checkbox"/>	<input type="checkbox"/>
Assessed by:			
3.	Wore appropriate PPE	<input type="checkbox"/>	<input type="checkbox"/>
4.	Acquired the correct materials and equipment	<input type="checkbox"/>	<input type="checkbox"/>
5.	All tray fixed securely and level/vertical	<input type="checkbox"/>	<input type="checkbox"/>
6.	All tray pieces coupled correctly	<input type="checkbox"/>	<input type="checkbox"/>
7.	All wall fixings secure and satisfactory	<input type="checkbox"/>	<input type="checkbox"/>
8.	All burrs and sharp edges removed	<input type="checkbox"/>	<input type="checkbox"/>
9.	Used only the materials specified in the material requisition	<input type="checkbox"/>	<input type="checkbox"/>
10.	Overall dimensions correct ($\pm 5\text{mm}$)	<input type="checkbox"/>	<input type="checkbox"/>
11.	Cable bearing surface undamaged	<input type="checkbox"/>	<input type="checkbox"/>
12.	Burrs, sharp edges and any vice marks removed	<input type="checkbox"/>	<input type="checkbox"/>
13.	Overall appearance to a commercially acceptable standard	<input type="checkbox"/>	<input type="checkbox"/>
14.	Work area conformed to requirements of HASAWA	<input type="checkbox"/>	<input type="checkbox"/>
15.	Correct safety procedures observed at all times	<input type="checkbox"/>	<input type="checkbox"/>
16.	Work area restored to a satisfactory condition on completion	<input type="checkbox"/>	<input type="checkbox"/>

Assessed by:

Start Date & Time: Finish Date & Time:

Target Time: 6 hours Time Taken:
